

Introduction

Having just filed our Annual Accounts with Companies House we are pleased to be weathering the current economic climate with turnover maintained and an improvement in profit. This is testament to the hard work of all Maxi employees and our various teams of Suppliers and Sub-contractors who have worked with us over the year.

We pride ourselves on the service we are offering Clients; this has continued to be monitored through the use of KPIs and, whilst there is always room for improvement, feedback demonstrates that we are achieving high levels of satisfaction.

We have been awarded some excellent contracts in the last period, with a range of values and categories which demonstrates our adaptability. Our tendering workload is healthy and additional staff have been recruited to accommodate the recent increased workload.

This is our 40th year of trading and, having taken a nostalgic view of the tenders we have submitted and contracts awarded over this period, our market sector has not changed significantly. Our ability to maintain and increase our presence shows that we are progressing towards our vision of being a 'Contractor of Choice'.

New Work Awards

Project Client	Value
Stevenston Business Centre Irvine Bay Developments Ltd	£1.6m
Refurbishment of Gourrock Outdoor Pool Inverclyde Council	£1.5m
Community Day Centre Shotts North Lanarkshire Council	£600k
Archive Store Refurbishment Edinburgh The City of Edinburgh Council	£425k
Classroom Extension to St Boswells Primary School Scottish Borders Council	£310k
Depot Roof Replacement Edinburgh The City of Edinburgh Council	£250k
Alterations to St Nicholas Primary School Broxburn West Lothian Council	£200k
Contact Centre Peebles Scottish Borders Council	£190k
Almondvale Avenue Upgrade Livingston Almondvale Livingston Ltd	£170k
Maintenance Shed Refurbishment Grangemouth John Mitchell Ltd	£95k
Retaining Wall Linlithgow Academy West Lothian Council	£50k

Linlithgow Burgh Halls

The £5.2m redevelopment of the Grade A listed Linlithgow Burgh Halls was completed in March. The project, to form a multi-purpose community arts centre featuring a display area, cafe, meeting and function space, involved external and internal refurbishment works including masonry repairs, damp-proofing, window and door installation, mechanical and electrical works and floor, wall and ceiling finishes. High quality finishes include oak flooring and wall lining, a feature stair with glass balustrading and modern chandeliers in the South Hall. The Client was West Lothian Council and the project team included Malcolm Fraser Architects, Waterman Building Services and Elliott and Company.



Project Completions

Alterations|Extension to Leisure Centre ▶ Rutherglen

This £1.4m project was for 381m² extension and alterations to 1152m² within an operational leisure centre for South Lanarkshire Council. The extended and upgraded centre provides a dance studio, changing accommodation, reception, cafe/restaurant, kitchen and toilet facilities. The works were phased to allow the continued operation of the leisure centre.

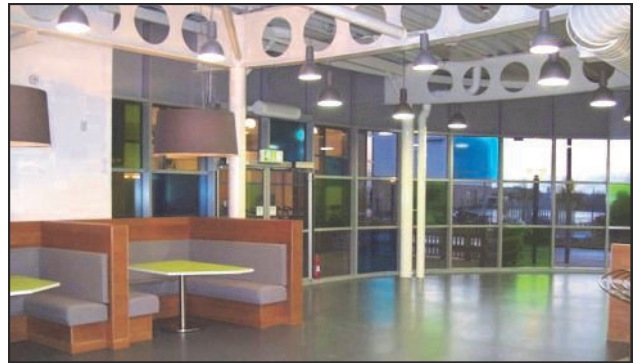

Fire Upgrading Works to Care Homes Edinburgh

£500k upgrading works, for The City of Edinburgh Council, to 12 occupied care homes to increase fire resistance of doors and screens from half hour to 1 hour standard.

Alterations|Extension to Kirkliston Primary School

Internal alterations and extension to an operational school, for The City of Edinburgh Council, to provide a staff room and resource room. The facilities were handed over to the school 2 weeks ahead of schedule.



◀ Alterations to Norvell Lodge Bathgate

£300k internal alterations to occupied sheltered housing complex for West Lothian Council to provide upgraded accommodation including kitchen/dining room, lounge and hairdressing salon. The new facilities are arranged around a central 'street' area within the building. The architect for the project was Nicoll Russell Studios.

Work Starts on Stevenston Business Centre

Work is progressing on the site of the new £1.6m Business Centre in Stevenston town centre for Irvine Bay Developments Ltd. The 2-storey building, designed by Cooper Cromar, will provide 1025m² of flexible, quality accommodation, including offices, workshops and retail space, for small and start-up businesses.

The 50-tonne structural steel frame has been erected. The building will feature zinc, natural stone and facing brick cladding and will incorporate cost-effective innovation, sustainability and green technology.

External works include access roads, car parking and landscaping.

We have entered into a Targeted Recruitment & Training programme in conjunction with the local CEiS (Community Enterprise in Scotland) office and this has resulted in our first new employee commencing on site in April.

